

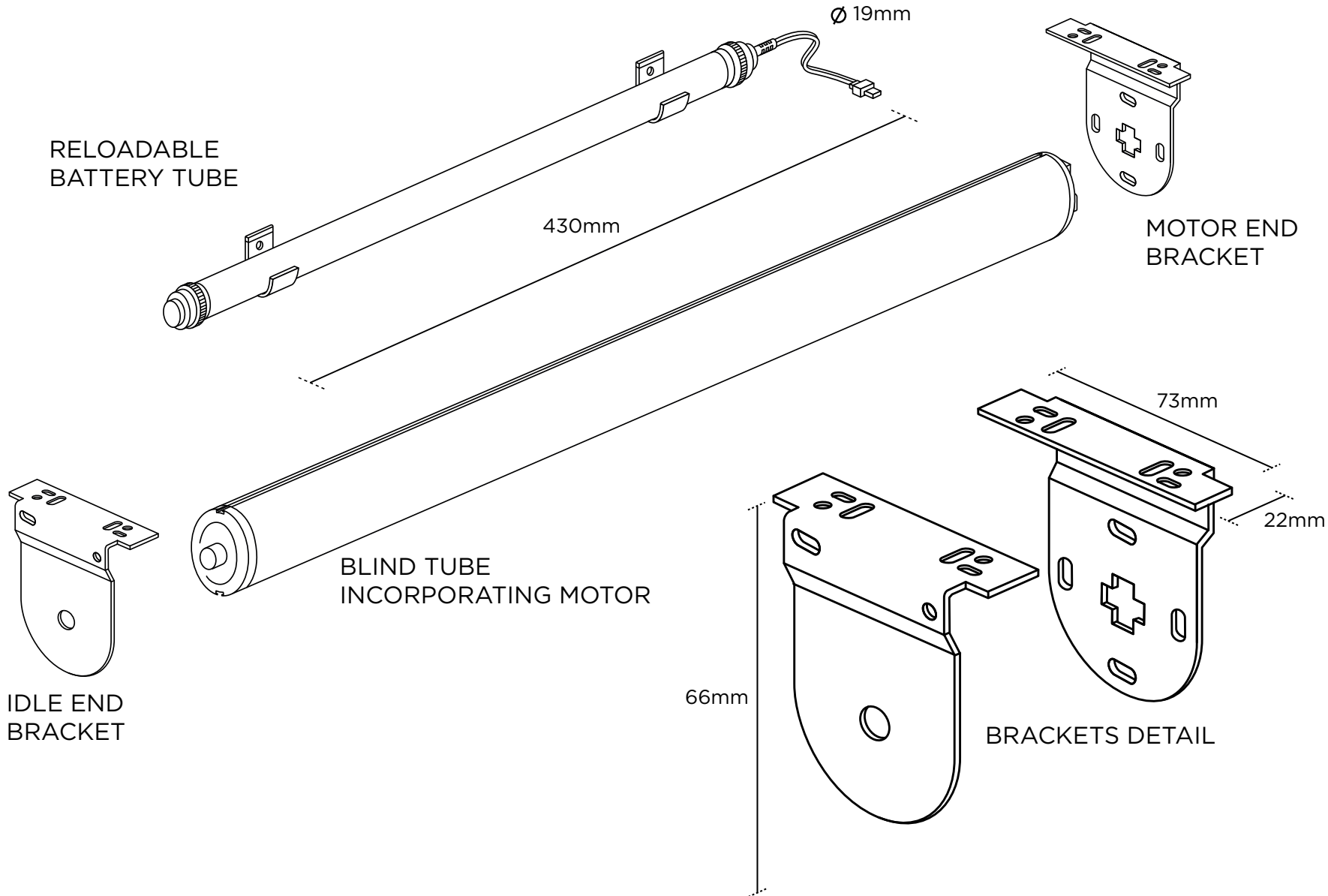

1 **PRODUCT GUIDE**

2 **POWER GUIDE**

3 **CONTROLS GUIDE**



- 1 **PRODUCT GUIDE**
- 2 POWER GUIDE
- 3 CONTROLS GUIDE

TOTAL UNIT MEASUREMENTS

Gap measurements between outer edge of brackets and fabric



Total rolled height of the blind unit including the bottom hem bar.

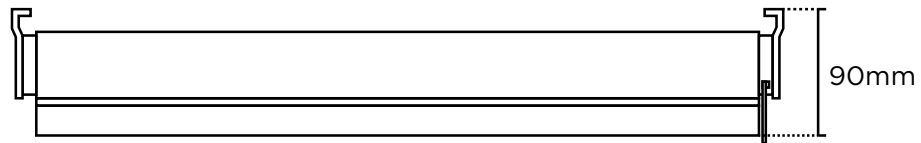

1 **PRODUCT GUIDE**

2 **POWER GUIDE**

3 **CONTROLS GUIDE**

FLEXIBLE MODULAR POWER OPTIONS.

There are four power options. All are an easy DIY installation with no electrical expertise required.

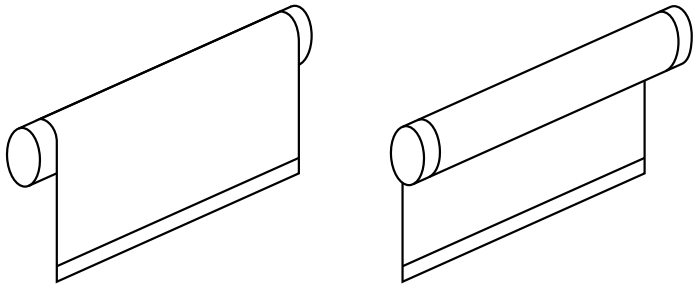

We can manufacture your blind to roll from the front or the rear.

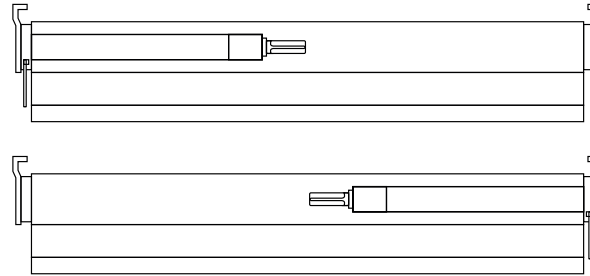

The motor can be fitted either on left or right hand side of your blind mechanism.

1. RELOADABLE BATTERY TUBE

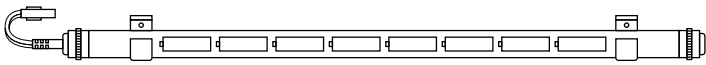

Use eight 1.5V Lithium AA batteries.

2. RECHARGEABLE BATTERY TUBE

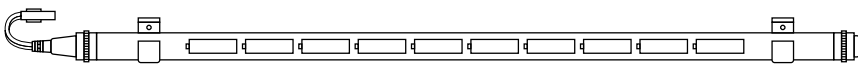

Use ten 1.2V rechargeable AA NiMH batteries.

3. SOLAR POWER PACK

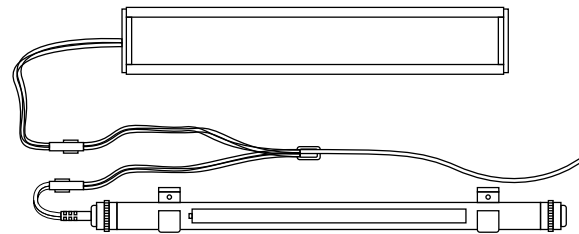

Harness the power of the sun to charge the single cell.

4. UK PLUG IN MAINS ADAPTOR

Plug our UK mains adaptor into the motor cord for a non battery option.

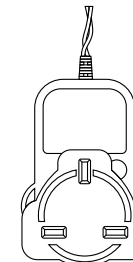

1 PRODUCT GUIDE

2 POWER GUIDE

3 CONTROLS GUIDE

SINGLE AND MULTI-CHANNEL CONTROLLER OPTIONS.

Controlling your blind is easy with an RTS remote control handset or programmable wireless controller. We have a large number to choose from to suit your specific requirements.

1 PRODUCT GUIDE

2 POWER GUIDE

3 CONTROLS GUIDE

- > Wireless control up to 20 metres with 2 concrete walls in between
- > Control multiple blinds from a single handset
- > No line of sight required
- > Configurable programming options for individual or groups of blinds



Telis 1 RTS Pure



Telis 4 RTS Pure



Telis 6 RTS Pure



Chronis Smart RTS



Smoove Black Shine

SINGLE AND MULTI-CHANNEL CONTROLLER OPTIONS.



TELIS 1 RTS PURE

Single channel remote control handset in white with grey trim. Ideal for controlling an individual powered blind.

- Battery powered (no wiring required).
- Supplied with a mounting pin (for wall mount option).
- Raise, lower and stop functions (open, close, stop).



TELIS 4 RTS PURE

Multi channel remote control handset in white with grey trim. Ideal for controlling multiple powered blinds individually and as a group.

- Battery powered (no wiring required).
- Supplied with a mounting pin (for wall mount option).
- Raise, lower and stop functions (open, close, stop).
- Channel selector button (5 channels).



TELIS 6 RTS PURE

- Greater comfort with centralization and time programming.
- Greater security with presence simulation that can be activated with a single click.
- Greater energy savings in winter with the dusk function.
- Greater peace of mind with automatic winter/summer time adjustment.



CHRONIS SMART RTS

- Single channel wall mounted controller.
- User programmable timed events for automatic control of blinds at set times.



SMOOVE WALL MOUNTED CONTROL UNIT

With touch-sensitive technology, Smoove interacts fluidly, intuitively and naturally with the home environment

You only need to lightly touch Smoove to create the movement you want... up, down, stop or "my" favourite position.

- Simple and flexible to install with no wires, no cables and no damage to décor.
- Easy to use, with an audible signal (beep) when the module is switched on via the on/off button.
- Can be mounted on recess boxes in new-build projects.



1 PRODUCT GUIDE

2 POWER GUIDE

3 CONTROLS GUIDE